

Energy Automation Solutions (EAS)

2024 Eaton EAS Conference Agenda



Powering Business Worldwide

Sheraton Station Square meeting room map

FIRST FLOOR



Stop by the Admiral Room to speak with sponsors, learn more about Eaton solutions at product booths, and visit the lounge for troubleshooting advice or to discuss 1:1 with an Eaton expert.

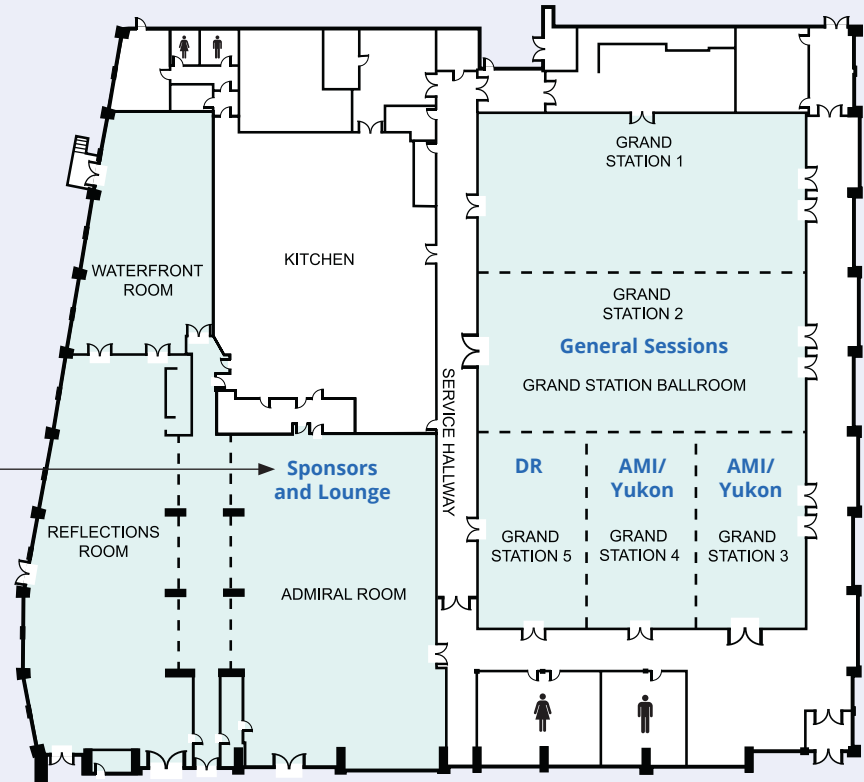

SECOND FLOOR

Wednesday: Hot Topics
Thursday: Power Delivery

Wednesday: Power Reliability
Thursday: Customer Experiences

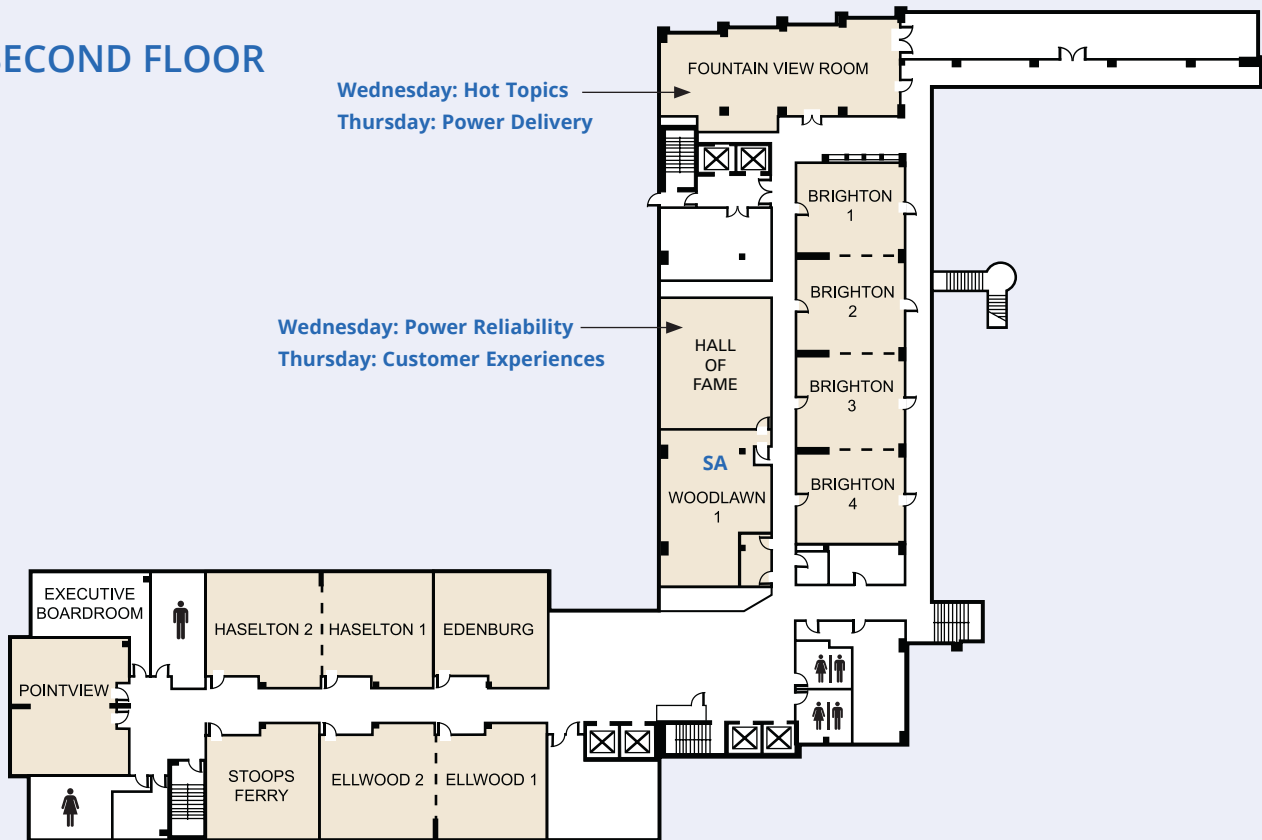

Pre-forum supplemental training sessions

Eaton Power Systems Experience Center
130 Commonwealth Drive, Warrendale, PA 15086

Eaton will offer pre-forum a.m. and p.m. sessions at our Power Systems Experience Center. These sessions will provide utility attendees/users with training and integration insights to maximize existing products and solutions.

Tuesday, May 14, 2024

7:00–8:00 a.m.	Breakfast—Reflections Room, Sheraton Station Square				
	Session 1	Session 2	Session 3	Session 4	Session 5
	Paid Training AMI/Yukon—Beginner	Paid Training AMI/Yukon—Advanced	Paid Training Demand Response	Paid Training Distribution Automation	Paid Training Substation Automation
Bus leaves from Sheraton Station Square hotel for PSEC facility at 8:20 a.m. Meet in lobby by front door.					
9:00–10:00 a.m.	AMI Training—Beginner Track: RF AMI Overview PSEC—Room 1 An introduction to Advanced Metering Infrastructure (AMI) including the fundamental concepts of the RF Mesh Network, an overview of AMI devices, and basic best practices. <i>Jeremy Bundermann, Rena Wang, D'Arrian Wilkom, and Jacob Burgoon</i>	AMI Training—Advanced Track: RF Network Overview PSEC—Room 2 Deep dive into concepts and field behavior of the Eaton RF Mesh Network, explained by Eaton engineers. <i>Owen Parry, William Corbalis, and Taylor Barto</i>	DR Training—Basic DR Setup PSEC—Room 3 Adding DR to your RFN AMI system? This session will discuss best practices for RFN DR and will provide attendees an opportunity to create and operate a RFN DR system in a test environment. <i>Elliott Mills, Yash Patel, Ryan Brager, and Larry Guenther</i>	DA Training—Feeder Automation Training PSEC—Room 4 Feeder automation training <i>Jasmin Giroux-Maltais and Charlene Ericson</i>	SA Training—SMP Gateway Basic Training PSEC—Room 5 SMP gateway basic training including configuration, tools, and debugging IED Management (IMS) basic training. <i>Justin Schwantes</i>
10:00 a.m.–12:00 p.m.	AMI Training—Beginner Track: Basic Yukon Training PSEC—Room 1 Basic Yukon training for new users including device pages, dashboards and widgets, device monitors, billing, device configurations, and more. <i>Jeremy Bundermann, D'Arrian Wilkom, and Jacob Burgoon</i>				
Bus leaves from Sheraton Station Square hotel for PSEC facility at 12:20 p.m. Meet in lobby by front door.					
12:00–1:00 p.m.	Lunch—PSEC				
1:00–3:00 p.m.	AMI Training—Beginner Track: Hardware Troubleshooting 101 PSEC—Room 1 This troubleshooting session covers field tool training, basic device troubleshooting, and FAQs. <i>Jeremy Bundermann</i>	AMI Training—Advanced Track: Advanced Hardware Troubleshooting PSEC—Room 2 This troubleshooting session for advanced users will cover best practices and troubleshooting tips for Gateways, Wi-Fi products, and electric meters. <i>Erik Ostigaard, Nathan Brown, Owen Parry, William Corbalis, Taylor Barto, George Koufaliotis, and Austin Mercado</i>	DR Training—Cellular DR Basics PSEC—Room 3 A robust two-way DR technology can replace your old one-way system or enhance your existing system. If you are new to DR, a cellular system might be right for you. This session will discuss the inner working of Eaton's Cellular DR offering. <i>Elliott Mills and Yash Patel</i>		SA Training—SMP Gateway Advanced Training PSEC—Room 5 SMP gateway advanced training Codesys/HMI <i>Justin Schwantes and Francois Turcotte</i>
3:00–4:00 p.m.		AMI Training—Advanced Track: Aggregated Points and Virtual Devices PSEC—Room 2 An overview of how to create and use virtual devices in Yukon to generate system and meter trends and calculate aggregated data points. <i>Jeremy Bundermann and David Sutton</i>			
Bus leaves from Sheraton Station Square hotel for PSEC facility at 3:30 p.m. Meet in lobby by front door. Bus will be available to take back to the Sheraton Station Square hotel for training participants who do not want to stay for the hospitality reception.					
4:00–6:00 p.m.	Networking—Hospitality Reception Eaton Power Systems Experience Center Hospitality Reception Eaton Power Systems Experience Center 130 Commonwealth Drive, Warrendale, PA 15086 Network with Eaton's industry experts while touring the Power Systems Experience Center. Enjoy cocktails and hors d'oeuvres while experiencing interactive applications and live demonstrations for utilities.				
Bus leaves from PSEC to Sheraton Station Square hotel at 4:15 p.m., 5:15 p.m., and 6:15 p.m.					

Eaton's EAS Users Conference—Sheraton Station Square

Wednesday, May 15, 2024

6:30–8:00 a.m.	Breakfast—Reflections Room				
8:00–8:15 a.m.	General Session: Welcome Grand Station 2 Welcome to Eaton's EAS User Conference <i>Thierry Godart</i>				
8:15–9:30 a.m.	Zap the Generational Gap Grand Station 2 Think you've already heard everything about the multiple generations? Think again! Unwilling to accept standard, by-the-book generalizations, Meagan Johnson tackles the generational challenges, myths, and misunderstandings head on. Meagan demonstrates to audiences through her own experience and in-depth research and program customization, that all generations have differences and strengths that go beyond mere age and appearance. <i>Meagan Johnson</i>				
9:30–10:45 a.m.	Utility Business Today and Tomorrow Grand Station 2 As the energy transition unfolds, electric utilities find themselves at the center of a dynamic landscape. Join us for an engaging talk on the trends impacting the industry. <i>Jason Plane</i>				
10:45–11:00 a.m.	Break				
11:00 a.m.–12:00 p.m.	DR Inverter Control Grand Station 2 The distribution system can limit the amount of renewables that can be connected. This limit might only be reached a few hours a year. How might DR control of exporting excess energy allow more renewables to be connected? <i>CJ Myers, Delaware Electric Cooperative</i>				
12:00–1:00 p.m.	Lunch—Reflections Room				
	AMI/Yukon	Demand Response	Substation Automation	Power Reliability	Hot Topics
1:00–2:00 p.m.	EV Control with AMI Disconnect Meters Grand Station 3 + 4 As EVs expand outside of cities, rural and smaller communities are now facing this grid strain. AMI disconnect devices can be another load control option for utilities to be responsive to load management needs while leveraging their existing devices. In this session, Detroit Lakes Public Utilities (MN) will discuss their EV challenges and how they implemented load control using Eaton's AMI Disconnect Meters. <i>Rena Wang, Bridget Penton, Amy Olson, and Nathan Lindblad from Detroit Lakes Public Utilities</i>	What's New with Eaton DR? Grand Station 5 Eaton DR Roadmap: What's new since last year and what we will be working on next year. <i>Ryan Brager</i>	SMP DA-3050 New Product and Roadmap Discussions Woodlawn Discussion on the new SMP DA-3050 automation platform, SMP technology roadmap and exchange with customer. <i>Francois Turcotte</i>	Tools and Strategies for Reliability Improvement Hall of Fame Utilities are measured by their customers and governing bodies alike on the reliability of the electric service they provide. This presentation will outline how reclosers and fault indicators can be used to improve reliability, strategies to deploy these technologies, and how software solutions like CYME and Feeder Automation can drive greater value and customer satisfaction out of the investment. <i>John Korn, Ryan Rausch, and Mikaela Mohaupt</i>	Enabling Grid-Edge Controls to Mitigate Rapid DER Growth and Electrification Fountainview The proliferation of DERs and prosumers have introduced challenges such as communication bottlenecks in centralized systems and faster system response times. Enabling controls activity at the grid edge near the data collection is key to mitigating these issues. Having a solution based on edge computing where containerized applications are leveraging model-based controls can support addressing these issues quickly and in a decentralized fashion. <i>Stuart Laval</i>
2:00–2:15 p.m.	Break				
2:15–3:15 p.m.	Metercat Training Grand Station 3 + 4 Metercat™ is used to communicate with Elster Electricity electronic meters for program development, meter programming, meter reading, meter testing, and report generation. <i>Octavio Reza, Honeywell</i>	Cellular DR Overview Grand Station 5 Do you plan to implement/add cellular switches to an existing Yukon system? This session will focus on how the system works and the two-way data available. <i>Elliott Mills and Yash Patel</i>	SMP D20 Migration at Norwood Woodlawn Present SMP16 migration with D20 to SG-4260 with SMP IO-2330. The benefits of using the Embedded Configuration Tool to simplify SMP IO-2330 integration. <i>Ange Kabeya</i>	FAM Customer Presentation Hall of Fame AEP success story with deployment of feeder automation manager. <i>Paul Pagur</i>	Predicting the Adoption of EVs using CYME Fountainview Using AMI data in CYME, we can track the adoption of EVs across a distribution area and predict future growth. <i>Mikaela Mohaupt</i>
3:15–3:30 p.m.	Break				
3:30–4:30 p.m.	Metercat Training, continued	Duke's Demand Response Cellular Transition Grand Station 5 This session will discuss the transition from a legacy one-way paging system to two-way cellular devices. <i>Michael Bogart, Duke Energy and Elliott Mills</i>	SMP Technology Applied to Distribution Applications Woodlawn With the penetration of DER and EV, the distribution grid has become more dynamic than ever, creating a need for increased situational awareness and decentralized automation. <i>Eric Lebeau and Francois Turcotte</i>	FAM User Group Hall of Fame Feeder automation manager roadmap discussion. <i>Jasmin Giroux-Maltais</i>	Fire Mitigation Innovations Fountainview Learn about how Eaton is evolving traditional apparatuses with innovative designs to address growing concerns about wildfire. <i>Brian Bertini, Ryan Rausch, and Michael Gresko</i>
5:30–9:00 p.m.	Networking—Shorty's Pins x Pints 353 N Shore Drive, Pittsburgh, PA 15212 (412) 904-4450 Latin-inspired street food, beverages and retro-gaming, duckpin bowling, pinball, darts, shuffleboard and bocce. https://www.shortysx.com/pins-x-pints/north-shore				

Bus leave from Sheraton Station Square hotel for Shorty's at 5:30 p.m. Buses leave from Shorty's to return to the hotel at 7:30 p.m. and 9:00 p.m.

Eaton's EAS Users Conference—Sheraton Station Square

Thursday, May 16, 2024

7:00–8:00 a.m.	Breakfast—Reflections Room				
8:00–9:00 a.m.	EASD Product Management World Tour Grand Station 2 Our EASD Product Management team will highlight new products, features, and opportunities at the conference to learn more. <i>Eric Lebeau, Jim Roche (or Ryan Brager), and Daniel Arden</i>				
9:00–10:00 a.m.	How AMI is Integrated into CYME Grand Station 2 What else can be done with AMI data? In this session we'll look at how it can be used to analyze the state of the distribution system and plan for future developments in CYME. <i>Mikaela Mohaupt, Michael Sharp, and Rena Wang</i>				
10:00–10:15 a.m.	Break				
10:15–10:45 a.m.	Unique Loads to Control: Crypto Mining, Casinos, and Confinement AG Grand Station 2 What are distinctive loads and challenges that affect your utility? This general session will be an interactive conversation regarding unique loads to control across utilities, including crypto mining, casinos, and more. This session is Part I of a two-part series, highlighting Outside-the-Box Demand Response thinking. <i>Elliott Mills and Yash Patel</i>				
10:45 a.m.–12:00 p.m.	What's Your Utility Doing? Grand Station 2 Customer Forum—A group discussion of EV chargers and other emerging grid challenges, software integrations such as CIS, OMS, etc., and other Q&A discussion using Menti. <i>Jeremy Bundermann</i>				
12:00–1:00 p.m.	Lunch—Reflections Room				
	AMI/Yukon	Demand Response	Substation Automation	Customer Experiences	Power Delivery
1:00–2:00 p.m.	What's New with Eaton AMI? Grand Station 3 and 4 What's new with Eaton AMI? What new products are we working on? <i>Jim Roche, Michael Sharp, and TJ LaPorte</i>	DR Workshop—What Issues Keep You Up at Night? Grand Station 5 Interactive session where attendees will divide into subgroups to express their DR challenges, then exchange ideas and workshop potential solutions together which will be presented at the end. <i>Rena Wang and Jimmy Kreuz</i>	IED Management (IMS) New Features and Roadmap Woodlawn IMS Roadmap: What's new since last year and what we will be working on over the next few years. <i>Patrick Cossette</i>	EESS/EASD Customer Success Stories Hall of Fame FAM (SCADA with FLISR): Turnkey solution offering by Eaton Engineering Services. <i>Dan Taormina, Jasmin Giroux-Maltais, and Vince White</i>	Volt/Var Optimization Planning Studies with the Dynamics of DER Fountainview How CYME can be used to optimize the configuration of installed capacitors, in-line regulators, and transformers with LTC in a distribution network with DER. <i>Mikaela Mohaupt</i>
2:00–2:15 p.m.	Break				
2:15–3:15 p.m.	Power Line Carrier—Celebration of Life Grand Station 3 and 4 Join us for a "celebration of life" of Eaton's Power Line Carrier (PLC) product line, moderated by Eaton's Product Line Managers. This session will also introduce current PLC users to the transition process to RF AMI. <i>Jim Roche, Michael Sharp, Dean Skinner, Jeremy Bundermann, and David Sutton</i>	Outside the Box DR Brainstorming Session Grand Station 5 Session to provide an opportunity for customers to introduce their creative demand response thinking—unique control wiring, loads focus, loads found, lessons learned from others. This session is Part II of a two-part series, highlighting Outside-the-Box Demand Response thinking. <i>Elliott Mills</i>	LGE KU Customer Presentation Woodlawn Learn how LGE KU is using IMS to perform firmware upgrades and remote changes on field devices. <i>Syd Ullis, LGE KU, and Patrick Cossette</i>	How's your Voltage? Volt/Var Management Operational Results Hall of Fame This presentation will review operational results from Volt/Var Management deployments reviewing operational issues and field performance. <i>Dan Arden</i>	Addressing New Challenges in the Capacitor Market Fountainview Eaton delivering innovations in distribution capacitors to address changing utility needs. Extreme temperatures, renewable challenges, cybersecurity, and other trends. <i>Michael Gresko and Troy Hedlund</i>
3:15–3:30 p.m.	Break				
3:30–4:30 p.m.	MyMeter—New Features Grand Station 3 and 4 Accelerated Innovations' MyMeter® is a hosted solution for utilities to deliver best-in-class digital experience to consumers and businesses. <i>Ed Houn, Accelerated Innovations</i>	DR Marketing and Customer Engagement Grand Station 5 For utilities of varying sizes, load types, demographics, and topography, how does each utility market their DR programs? What has worked and what hasn't? This session will be a conversation on marketing demand response and engaging more groups that fall outside of the traditional demographics. <i>Rena Wang and Joe Schlüsselberg</i>	Edge Computing at AEP Woodlawn Moving from data concentration at the substation level to data concentration at a centralized level. <i>James Begell, AEP</i>	Our Distribution Automation Products Interactive Session with New Products Hall of Fame Conference Special: Receive an insider's view of Eaton's Next Generation GridAdvisor FCI and Capacitor Bank Control. Interact with our early prototypes to provide feedback, comments, and suggestions to Eaton. <i>Troy Hedlund and Ryan Rousch</i>	Distributed Energy Resources and Voltage Regulation Fountainview Growing numbers of EV chargers and DERs are contributing to power distribution issues. Learn more about our voltage regulator offerings, including new products currently in development. <i>Dan Daley and Kyle Heiden</i>
5:30–8:30 p.m.	Networking—Gateway Clipper Gateway Clipper River Boat Dinner Cruise 350 W Station Square Drive, Pittsburgh, PA 15219 (412) 355-7980 Networking with a superb view of the Pittsburgh skyline while enjoying dinner, cocktails, and a DJ on the Gateway Clipper River Boat. Meet in lobby at 5:15 p.m. to walk to dock behind the hotel. https://www.gatewayclipper.com/				

Eaton's EAS Users Conference—Sheraton Station Square

Friday, May 17, 2024

7:00–8:00 a.m.	Breakfast—Reflections Room
8:00–10:00 a.m.	New Product Development Grand Station 2 Voting on potential Eaton EAS product development. Must be present to vote. <i>Thierry Godart</i>
10:00–10:15 a.m.	Closing Comments Grand Station 2 Thank you for attending the 2024 Eaton Users' Group. <i>Thierry Godart</i>



Notes



For more information, visit
eatonconferences.com

Eaton
1000 Eaton Boulevard
Cleveland, OH 44122
United States
[Eaton.com](https://eaton.com)

©2024 Eaton
All Rights Reserved
Printed in USA
Publication No. BR910012EN / Z28743
April 2024

EATON
Powering Business Worldwide

Eaton is a registered trademark.
All other trademarks are property
of their respective owners.

Follow us on social media to get the
latest product and support information.

